

# BS Elektronik Service GmbH

(A) Electronics And Optical Characteristics: Ta=25°C

PART NO	Emitting Color	Forward Voltage Unit: V	Totality Luminous Intensity Unit: LM	Single LED Axial Intensity Unit: mcd	Dominant Wavelength Unit: nm	Viewing Angle Unit: deg	Color Temperature Unit: K°
SE-3FR	Super Red	6.0	1.7	320	630	95	<=1500
SE-3FY	Super Yellow	6.0	1.9	360	595	95	<=1500
SE-3FG	Ultra Green	6.0	4.5	1500	525	78	7400
SE-3FB	Super Blue	6.0	1.3	280	470	85	>=25000
SE-3FW	Super White	6.0	3.0	900	X:0.29 Y:0.28	85	8800
SE-3FUW	Ultra White	6.0	4.6	1300	X:0.29 Y:0.29	75	8000
<b>Test Condition</b>		<b>IF=20mA</b>	<b>IF=20mA</b>	<b>IF=20mA</b>	<b>IF=20mA</b>	<b>IF=20mA</b>	
<b>IR max: 0.01mA; VR=5V</b>							

Figure :

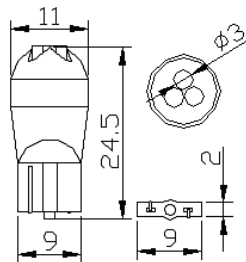

## (B) Absolute Maximum Ratings AT Ta=25°C

PARAMETER	MAX	UNIT
Continuous Forward Current	25	mA
Peak Forward Current (1/10 Duty Cycle 0.1ms Pulse Width)	100	mA
Reverse Voltage	5	V
Operating Temperature Range	-30°C to +85°C	
Storage Temperature Range	-40°C to +100°C	
Lead Solder Temperature 1.6mm Below Package 260°C For 5 seconds		